

**LINCOLN COUNTY HIGHWAY DEPARTMENT**

Post Office Box 97  
Ivanhoe, Minnesota 56142

Joseph M. Wilson, P.E.  
E-Mail: [jwilson@co.lincoln.mn.us](mailto:jwilson@co.lincoln.mn.us)  
Phone: 507-694-1464  
Fax: 507-694-1101

**ADDENDUM**

Date: July 9, 2020

To: All Planholders of Record

Subject: Contract No. 02-2020

Addendum No. 1

Date of Letting: July 14, 2020

**A) Plan Addendum Items**

1. **PLAN SHEETS G-102 & G-103** are hereby removed and replaced with attached G-102 and G-103. Changes were made due to the following:
  - a) Item numbers did not match 2018 MnDOT Spec. Book Items.
  - b) Item "Concrete Curb and Gutter Design B612" was added. Existing curb and gutter around courthouse parking lot is B612. Changed proposed courthouse curb and gutter to match into existing.
  - c) Sidewalk, catch basin #2, and pedestrian ramp at highway building is moved/extended to the east 2 ft. and concrete pavement is reduced by 2 ft. (Attached Amended **Plan Sheet C-205a**).
  - d) Quantity of Item "Place Concrete Pavement" changed due to catching an error, changing courthouse curb and gutter to B612, and changes to highway concrete pavement, all mentioned above.
  - e) Quantity of Item "5" Concrete Walk" changed due to changes to highway concrete walk, mentioned above.

Bidders shall acknowledge the receipt of this addendum according to the provisions of Mn/DOT 1210.

Sincerely,

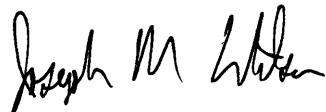

Joseph M. Wilson, P.E.  
Lincoln County Engineer

**Attachments:** Amended Plan Sheets (3 Pages)

# HANDICAP PARKING

# AREA IN FRONT OF THE HWY. DEPARTMENT

SEE SHEET C-205



# ADDENDUM 1

DRIVING AREA

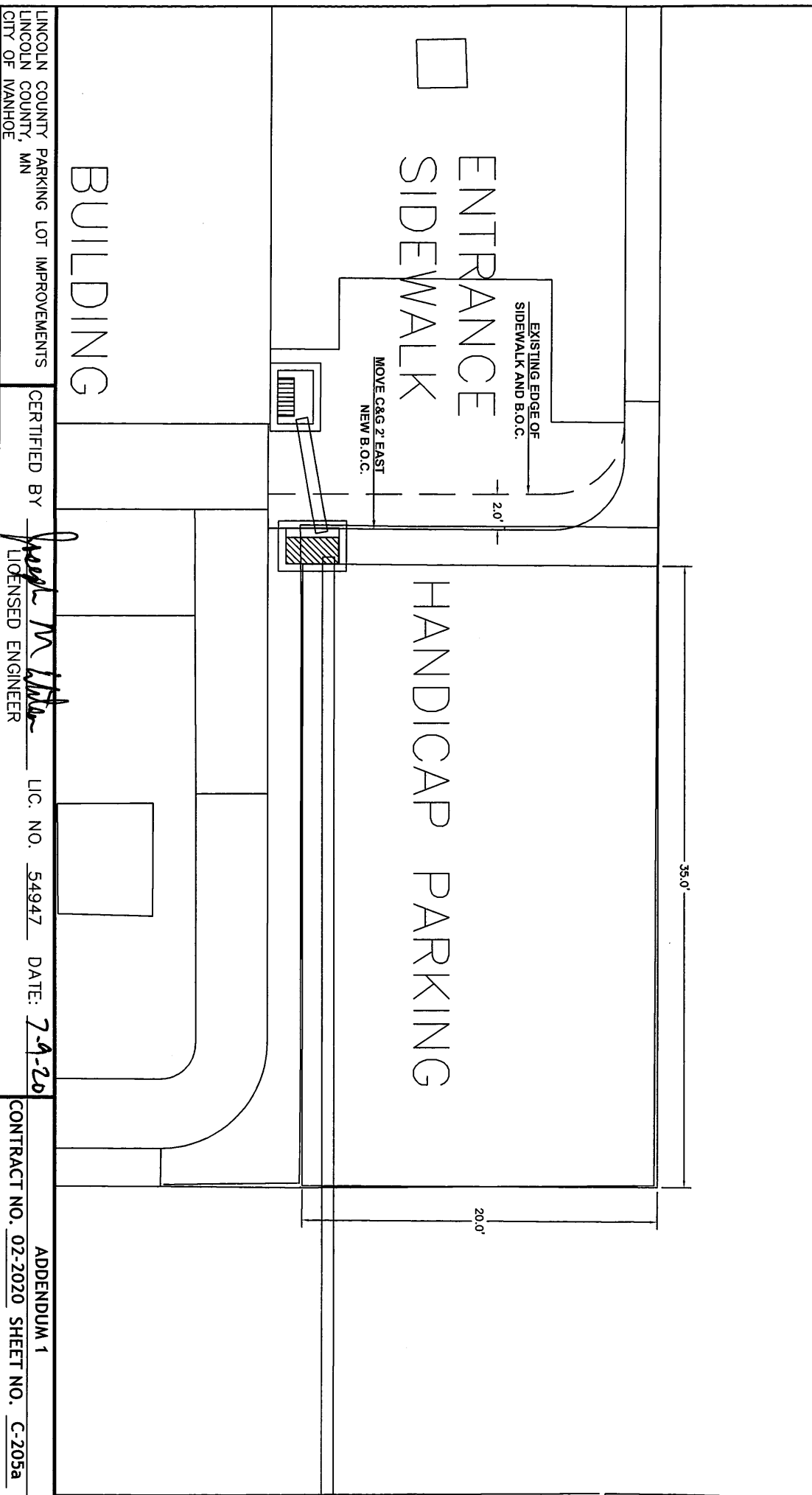

LINCOLN COUNTY PARKING LOT IMPROVEMENTS  
LINCOLN COUNTY, MN  
CITY OF WANHOE

CERTIFIED BY *Joseph M. Linder*  
LICENSED ENGINEER

L.C. NO. 54947 DATE: 7-9-20

ADDENDUM 1  
CONTRACT NO. 07-2020 SHEET NO. C-205a

# ADDENDUM 1

## TABULATION OF STREET & SIDEWALK QUANTITIES

LOCATION	CLASS 5 GRAVEL DEPTH (INCH)	SALVAGE GRAVEL DEPTH (INCH)	CONCRETE PAVEMENT THICKNESS (INCH)	GRAVEL AREA (SQ YD)	PLACE CONCRETE PAVEMENT * (SQ YD)	AGGREGATE BASE CLASS 5 (TON)	TOTAL EXCAVATION (CU YD)	CURB AND GUTTER (LIN FT)		VALLEY GUTTER (LIN FT)	5" SIDEWALK (SQ FT)	TRUCTATED DOMES (SQ FT)	4" TYPE SP 12.5 NON-WEARING COURSE MIX 2C (SQ YD)	BITUMINUS MATERIAL FOR TACK COAT (GALLON)
								B612	B618					
<b>COURTHOUSE</b>														
PARKING LOT	12	0	6	620	579	490	730	335	0	0	0	0	0	0
PARKING LOT SIDEWALK & RAMP	4	0	0	35	0	10		0	0	0	302	20	0	0
2' & 5' SIDEWALK	4	0	0	21	0	10		0	0	0	187	0	0	0
<b>HIGHWAY DEPARTMENT</b>														
DRIVEWAY	12	0	6	115	115	90	150	0	56	0	0	0	0	0
CONCRETE PAVEMENT & CURB	12	0	6	85	78	70		0	65	0	0	0	0	0
SIDEWALK	4	0	0	46	0	10		0	0	0	455	8	0	0
DRAIN TILE	8	0	0	77	0	40		0	15	17	0	0	65	10
<b>TOTALS</b>	----	----	----	----	772	720	880	335	136	17	944	28	65	10

\* ITEM INCLUDES THE STRUCTURAL CONCRETE

## TABULATION OF STREET & SIDEWALK QUANTITIES

LOCATION	REMOVE CURB & GUTTER (LIN FT)	REMOVE SIDEWALK (SQ FT)	REMOVE CONCRETE PAVEMENT (SQ FT)	REMOVE VALLEY GUTTER (SQ FT)	REMOVE BITUMINOUS PAVEMENT (SQ FT)	REMOVE CATCH BASIN & CASTING (EACH)	PAVEMENT MARKING REMOVAL (LIN FT)	PAVEMENT MARKING REMOVAL* (SQ FT)	SALVAGE HANDICAP SIGN** (EACH)	CLEAR & GRUB TREE *** (LUMP SUM)
<b>COURTHOUSE</b>	164	460	235	----	----	----	132	20	2	1
<b>HIGHWAY DEPARTMENT</b>	136	255	745	75	580	1	----	----	1	----
<b>TOTALS</b>	300	715	980	75	580	1	132	20	3	1

\*ITEM INCLUDES REMOVAL OF 2 HANDICAP PAVEMENT MESSAGE SIGNS & NO PARKING ZONE

\*\*ITEM INLCUDED REMOVAL & REINSTALLATION AT LOCATION SHOWN ON PLANS

\*\*\*ITEM INCLUDES CLEARING & GRUBBING OF 6 TREES

## TABULATION OF ROAD STRIPING

LOCATION	4" SOLID LINE WHITE EPOXY (LIN FT)	PAVEMENT MESSAGE (HANDICAP) PARKING EPOXY (SQ FT)
COURTHOUSE	365	20
HIGHWAY DEPARTMENT	143	10
<b>TOTALS</b>	<b>508</b>	<b>30</b>

# QUANTITY TABLES

CERTIFIED BY  LIC. NO. 54947 DATE: 7-9-20

CONTRACT NO. 02-2020 SHEET NO. G-103

# ADDENDUM 1

ITEM NUMBER	DESCRIPTION	UNITS	CONTRACT QUANTITY
2021.501	MOBILIZATION	LUMP SUM	1
2101.501	CLEARING & GRUBBING	LUMP SUM	1
2102.503	PAVEMENT MARKING REMOVAL	LIN FT	132
2102.518	PAVEMENT MARKING REMOVAL	SQ FT	20
2104.502	REMOVE CATCH BASIN & CASTING	EACH	1
2104.502	SALVAGE HANDICAP SIGN	EACH	3
2104.503	REMOVE CURB AND GUTTER	LIN FT	300
2104.518	REMOVE SIDEWALK	SQ FT	715
2104.518	REMOVE CONCRETE PAVEMENT	SQ FT	980
2104.518	REMOVE VALLEY GUTTER	SQ FT	75
2104.518	REMOVE BITUMINOUS PAVEMENT	SQ FT	580
2105.507	COMMON EXCAVATION (P)	CU YD	880
2211.509	AGGREGATE BASE CLASS 5	TON	720
2211.607	3/4" CRUSHED ROCK	CU YD	114
2301.504	PLACE CONCRETE PAVEMENT*	SQ YD	772
2357.506	BITUMINOUS MATERIAL FOR TACK COAT	GALLON	10
2360.504	TYPE SP 12.5 WEARING COURSE MIXTURE (2,B) 4.0" THICK	SQ YD	65
2503.503	8" PIPE SEWER DESIGN, PERFORATED HDPE	LIN FT	465
2503.503	16" PIPE SEWER DESIGN, HDPE	LIN FT	4
2506.502	CASTING ASSEMBLY - R2557	EACH	1
2506.502	CASTING ASSEMBLY - R3067	EACH	1
2506.502	CASTING ASSEMBLY - R3076	EACH	1
2506.503	CONSTRUCT DRAINAGE STRUCTURE 4' DIA STORM MANHOLE	LIN FT	4.17
2506.503	CONSTRUCT DRAINAGE STRUCTURE 2' X 3' CATCH BASIN	LIN FT	7.58
2511.504	GEOTEXTILE FILTER TYPE 3	SQ YD	227
2521.518	5" CONCRETE WALK	SQ FT	944
2531.503	CONCRETE CURB AND GUTTER DESIGN B612	LIN FT	335
2531.503	CONCRETE CURB AND GUTTER DESIGN B618	LIN FT	136
2531.603	CONCRETE VALLEY GUTTER	LIN FT	17
2531.618	TRUNCATED DOMES	SQ FT	28
2563.601	TRAFFIC CONTROL	LUMP SUM	1
2573.502	STORM DRAIN INLET PROTECTION	EACH	3
2574.507	COMMON TOPSOIL BORROW	CU YD	121
2574.508	FERTILIZER TYPE 3	POUND	45
2575.505	SEEDING	ACRE	0.14
2575.508	SEED MIXTURE 25-131	POUND	20
2575.508	HYDRAULIC MULCH MATRIX	POUND	224
2582.518	PAVEMENT MESSAGE (HANDICAP) EPOXY	SQ FT	30
2582.603	LINEAR MARKING 4" WIDE EPOXY WHITE	LIN FT	508

\*ITEM INCLUDES THE STRUCTURAL CONCRETE